

# Quick Installation Guide

## WP-919-V2



*As Simple As It Gets!*

# Table of contents

|          |                       |        |
|----------|-----------------------|--------|
| <b>1</b> | PnV2 App Installation | Page 2 |
| <b>2</b> | Registration          | Page 2 |
| <b>3</b> | Add Camera            | Page 3 |
| <b>4</b> | Additional Actions    | Page 8 |



# מצלמת רשת ביתית PnV Provision-ISR

מדריך התקנה:

## 1 PnV2 App Installation

- Install the free 'Provision PnV2' App on your device.
- Open the App and register for it.



Scan for  
iOS /Android



## 2 Registration

Enter your account

Enter your password

Remember Password

**Sign in**

[Forgot Password](#) [Quick Registration](#)

- Click on '**Register new**' or '**Quick Registration**'.

Username

Please enter the password

**Submit**

NOTE:  
1. Username format: the length must be between 6 and 50 characters, containing digits, letters, and underline scores only. Other strings are invalid.  
2. Password format: the length must be between 8 and 31 characters containing digits and letters only. Special characters are invalid, and the letters are

- Input the desired username and password.
  - Note:** The username must be at least 6 characters long, and the password at least 8 characters (letters and digits.)
- Click on '**Submit**'.
  - Note:** After registration, **it is recommended to bind an email address with the account for password reset** (if necessary.)

### 3 Add Camera

#### A. Camera Installation using the App's QR code

(The camera is reset and connected to power only (no network cable))

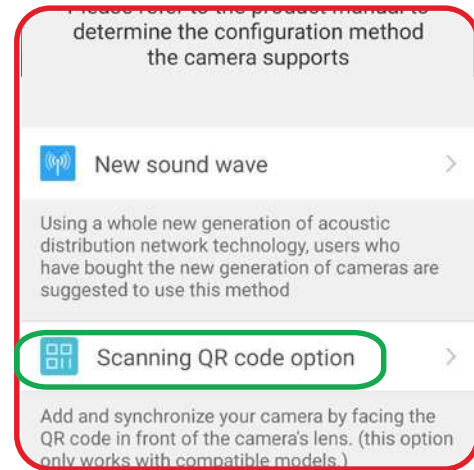
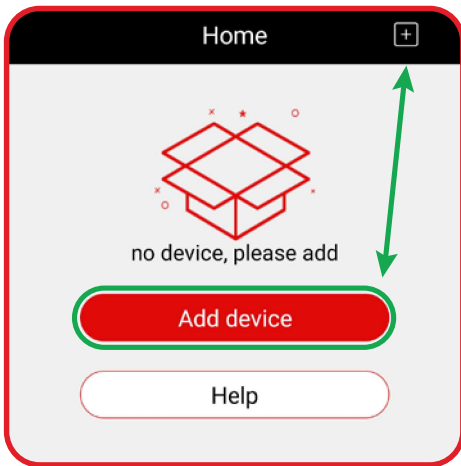

1. The camera will prompt the message: **"wireless connection waiting."**
2. On the home page, click the **+** at the upper left corner or the **'Add device'** button.  
• **Note: for this procedure to be successful, your smartphone must be wirelessly connected to the same network you want the camera to connect to.**

3. Click on the **'Others'** icon located at the bottom of the scan page.
4. Choose the **'Scanning QR code option.'**

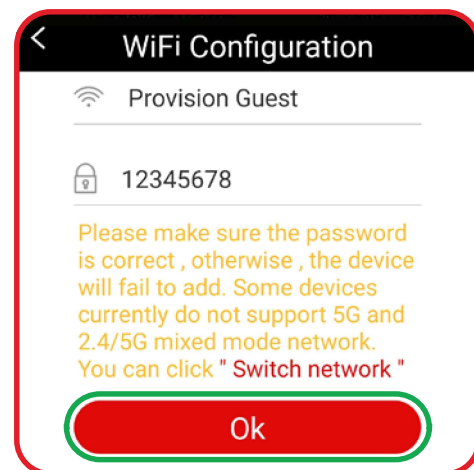
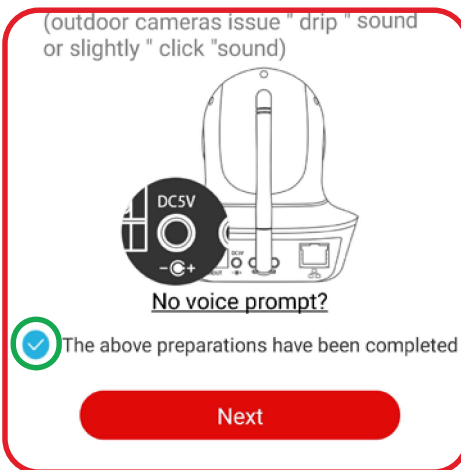

5. Tick the circle **✓** to confirm that the required preparations have been completed.
6. Click on **'Next.'**

7. The WiFi network the smartphone is connected to will be displayed. **Please ensure it is the right network** before proceeding.
8. Please enter the wireless network's **password** and click **'OK.'**
9. A pop-up message will ask you to confirm the password. Click on **'Confirm it'** to continue.

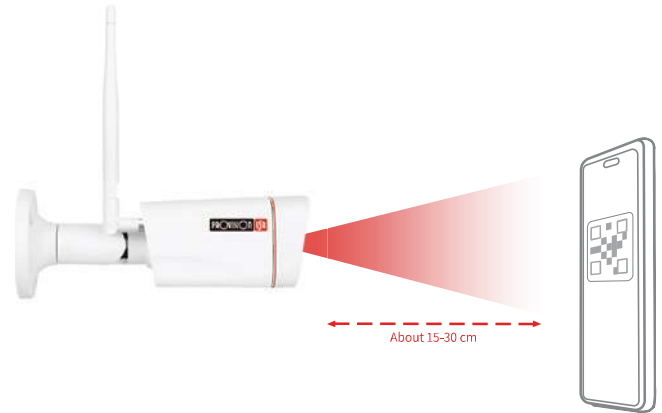

10. Please **place the QR code display on your phone screen** in front of the camera lens from a distance of 15-30 cm.

11. If the scan is successful, the App will prompt the message: "wireless connection success."



12. Click the '**Add it**' button in the pop-up window to finish the camera installation process.

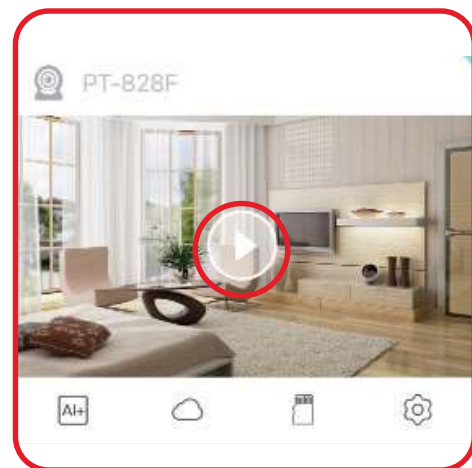

13. After the camera has been added successfully, you can start watching by clicking the button on the home page.

## B. Wireless Installation (supported on specific models only) (The camera is reset and connected to power only (no network cable))

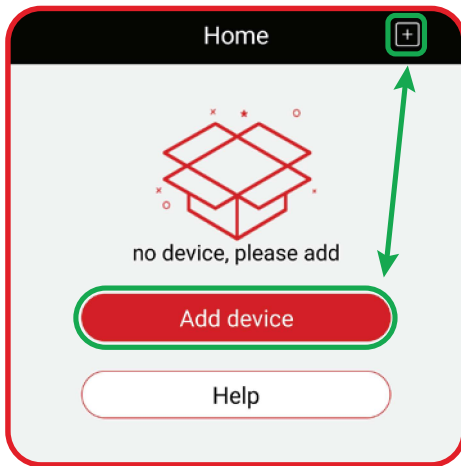

• **Note:** for this procedure to be successful, your smartphone must be wirelessly connected to the same network you want the camera to connect to.

1. The camera will prompt the message: **“Wireless connection waiting.”**
2. On home page, click the **+** at the upper right corner or the **'Add device'** button.

3. Scan the **QR code** located at the bottom of the camera.

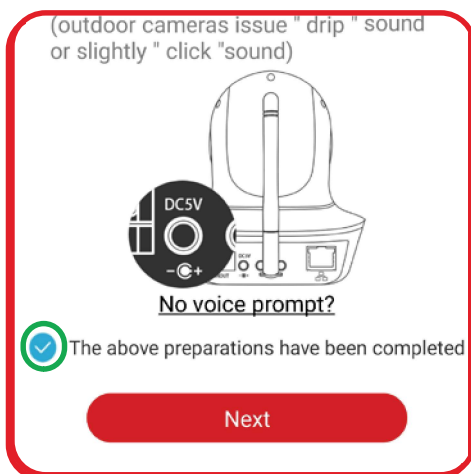

4. Tick the circle **✓** to confirm that the required preparations have been completed.
5. Click on **'Next.'**

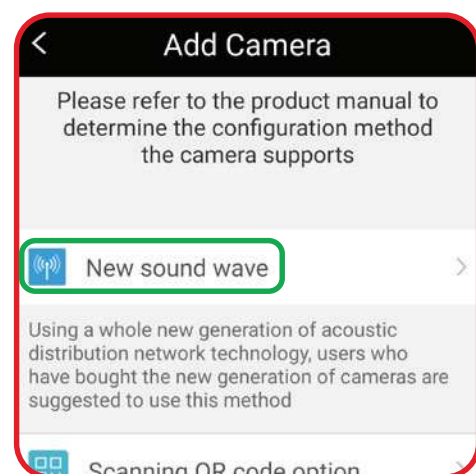

- **Note:** If the App fails to scan the QR code on step 3, you can add the camera wirelessly by clicking on the **'Others'** icon located at the bottom of the scan page, selecting the **'New sound wave'** option, and repeating steps 4-12.

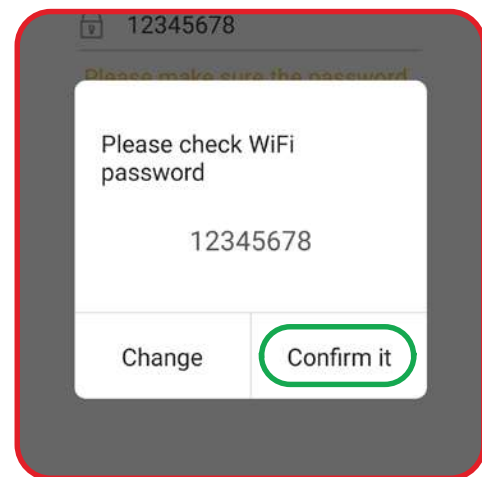
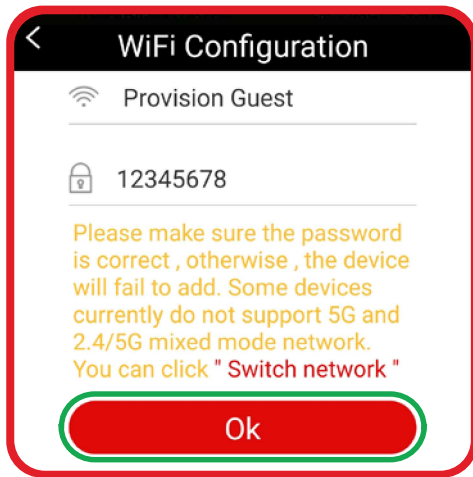

6. The WiFi network the smartphone is connected to will be displayed. **Please ensure it is the right network** before proceeding.  
 7. Please enter the wireless network's **password** and click '**OK.**'

8. A pop-up message will ask you to confirm the password. Click on '**Confirm it**' to continue.

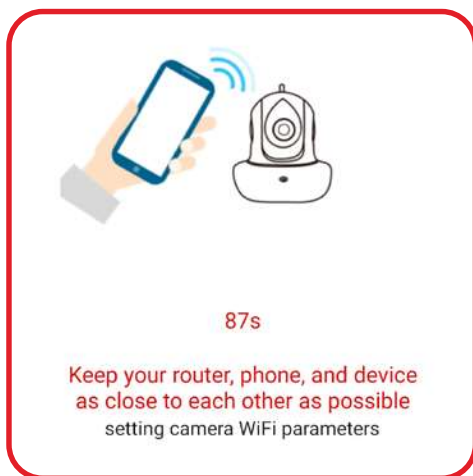

9. The App will transmit an encrypted connection sound. Please ensure the **mobile phone volume** is maximum and as **close to the camera** as possible.

10. When the wireless synchronization is finished, the App will prompt the message: "**wireless connection success.**"  
 11. Click the '**Add it**' button in the pop-up window to finish the camera installation process.

## C. Camera Installation by local network search

(The camera is reset, connected to power, and to the router)

• **Note:** for this procedure to be successful, your smartphone must be wirelessly connected to the same network you want the camera to connect to.

1. On the home page, click the  at the upper right corner or the 'Add device' button.
2. Click on the 'Others' icon located at the bottom of the scan page.

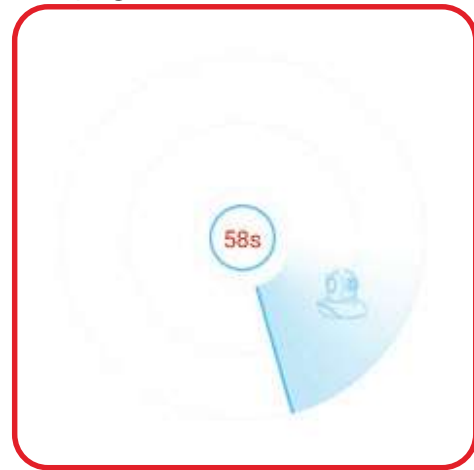
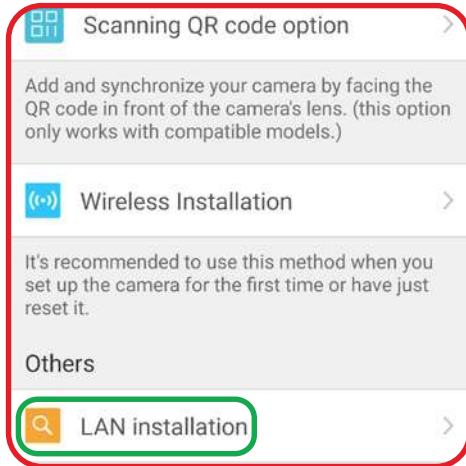



3. Click the '**LAN** installation' option.
4. Click on "**Already connected to Ethernet cable**" at the bottom of the screen.

5. The App will perform a search for the camera on the network.
6. If the camera is connected correctly, the App will locate it and ask to add it.
7. Click the '**Add it**' button to finish the camera installation process.

## D. Manual Installation

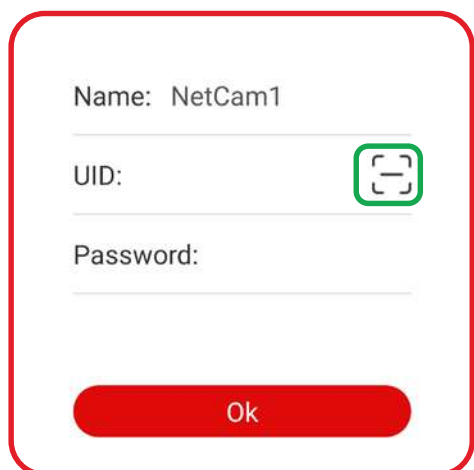
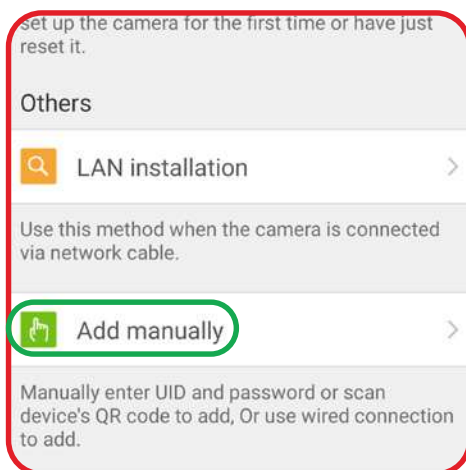
(The camera is reset, connected to power, and to the router)



1. On the home page, click the  at the upper right corner or the '**Add device**' button.
2. Click on the '**Others**' icon located at the bottom of the scan page.
3. Click the '**Add manually**' option.

4. Click the '**scan**' icon and scan the QR code located on the side or bottom of the camera, or enter the camera's UID using the keyboard.
5. Enter the default password: **888888**
6. Click the '**OK**' button to finish the camera installation process.



## 4 Additional Actions

### A. Camera Sharing

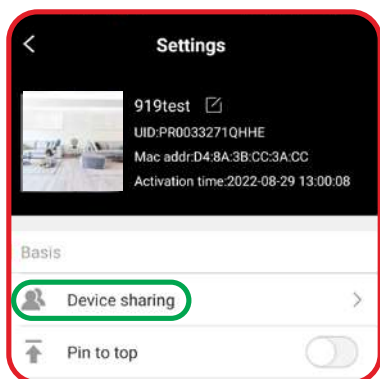

1. Click the settings (**gear icon**) located below the camera image on the home page.
2. Click the '**Device sharing**' option.

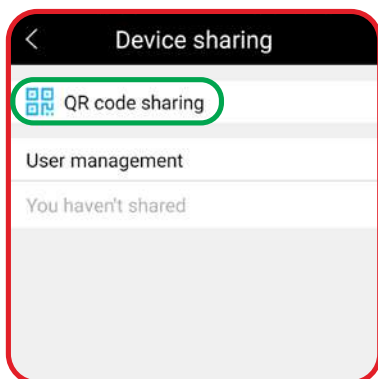

3. Click on '**QR code sharing**'.



4. You can save the QR code as an image to your mobile phone gallery by clicking '**Save pictures**' at the bottom of the screen and sending it to the user with whom you share the camera.
- **Important:** the code is dynamic and valid for about half an hour.
5. If the camera sharing is successful, the user with whom it is shared will be asked to add it.

### B. Cloud Storage

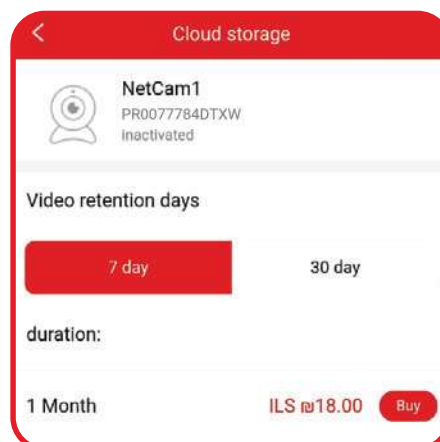

- 1-Click the cloud icon located below the Camera image on the home page.
  - 2- Pick the desired plan (there are two: 7-day and 30-day retentions.) **Cloud recordings are motion based only!**
- **Note:** Cloud recordings are accessible Depending on the purchased plan, even if The camera is unplugged or stolen. The recordings are available if the camera has yet to be deleted from the account.

### C. Camera Reset



1. The camera is connected to power.
2. Turn the camera head vertically to reveal the SD card slot and the Reset button.
3. Press the Reset button for **10 seconds** or Until you hear the message prompt: "**Device will restart.**"



The guide is available for download at the company's website: [www.pikok.co.il](http://www.pikok.co.il)

**Technical Support:**

**Website:** <http://pikok.co.il>

**Tel:** 073-7500848 / **WhatsApp:** 050-7337235

**Provision-ISR Group, 11 Atir Yeda St., Kfar Sava, 4464310**